

Material: Brass Nickel Plated
Working Temperature: -20 ÷ 80 C°
Working Temperature: -4 ÷ 176 F°
Working Pressure (max): 20 bar
Working Pressure (max): 290 psi
Vacuum: -99 kPa
Vacuum: 29" Hg
Conformity: Silicone Free

Conformity: RoHS
Conformity:
Conformity:
Conformity:
Application Pneumatic circuits

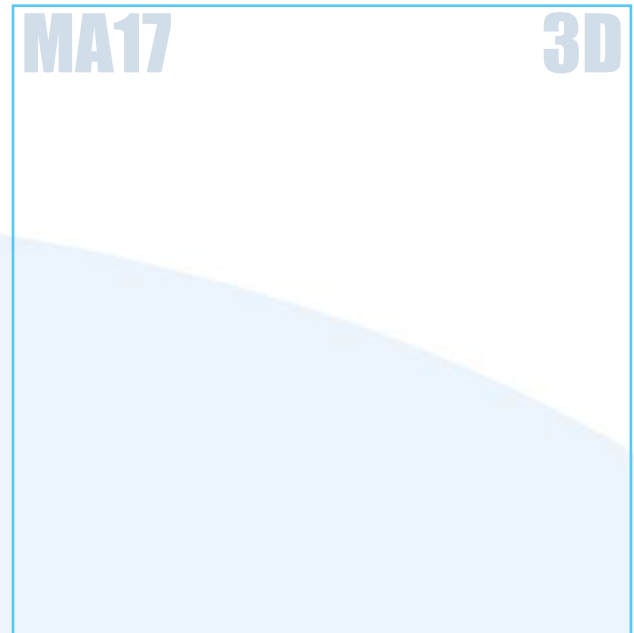
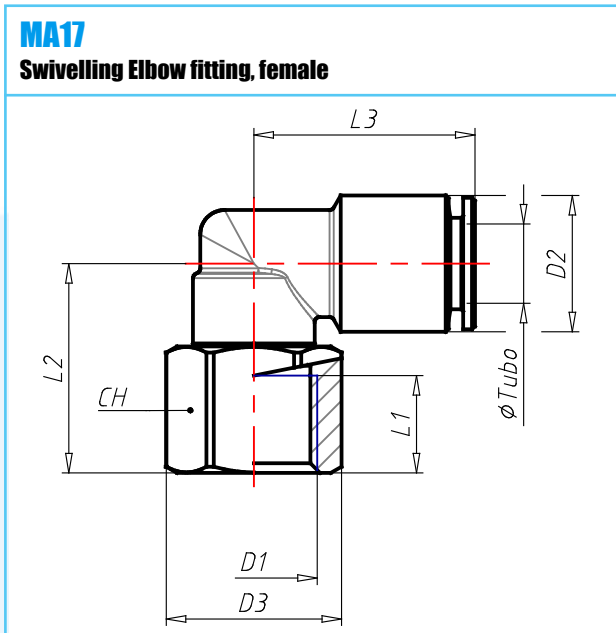

CODE	TYPE	DTUBO	D1	D2	D2IN	D3	D3IN	L1	L1IN	L2	L2IN	L3	L3IN	CH	G	GOZ	WTF	WPP	TVH
A0070011	MA17 04 18 4	4	G1/8	9.1	.358	14.5	.571	6.5	.256	17.9	.705	19.5	.768	13	17.3	.610	-4 ÷ 176	290	29"
A0070031	MA17 06 18 6	6	G1/8	12.0	.472	14.5	.571	6.5	.256	17.9	.705	22.0	.866	13	19.7	.695	-4 ÷ 176	290	29"
A0070032	MA17 06 14 6	6	G1/4	12.0	.472	18.0	.709	10.0	.394	22.2	.874	22.0	.866	16	25.4	.896	-4 ÷ 176	290	29"
A0070041	MA17 08 18 8	8	G1/8	14.0	.551	14.5	.571	6.5	.256	17.7	.697	22.5	.886	13	23.1	.815	-4 ÷ 176	290	29"
A0070042	MA17 08 14 8	8	G1/4	14.0	.551	18.0	.709	10.0	.394	22.0	.866	22.5	.886	16	29.1	1.026	-4 ÷ 176	290	29"
A0070052	MA17 10 14 10	10	G1/4	16.0	.630	18.0	.709	10.0	.394	23.0	.906	26.0	1.024	16	35.6	1.256	-4 ÷ 176	290	29"
A0070053	MA17 10 38 10	10	G3/8	16.0	.630	22.5	.886	10.5	.413	25.0	.984	26.0	1.024	20	43.5	1.534	-4 ÷ 176	290	29"