

**Material:** Brass Chrome Plated  
**Working Temperature:** -20 ÷ 80 C°  
**Working Temperature:** -4 ÷ 176 F°  
**Working Pressure (max):** 0 ÷ 10 bar  
**Working Pressure (max):** 145 psi  
**Vacuum:** kPa  
**Vacuum:** Hg  
**Conformity:**

**Conformity:**  
**Conformity:**  
**Conformity:**  
**Conformity:**  
**Application** Pneumatic installations fed with filtered, lubricated air

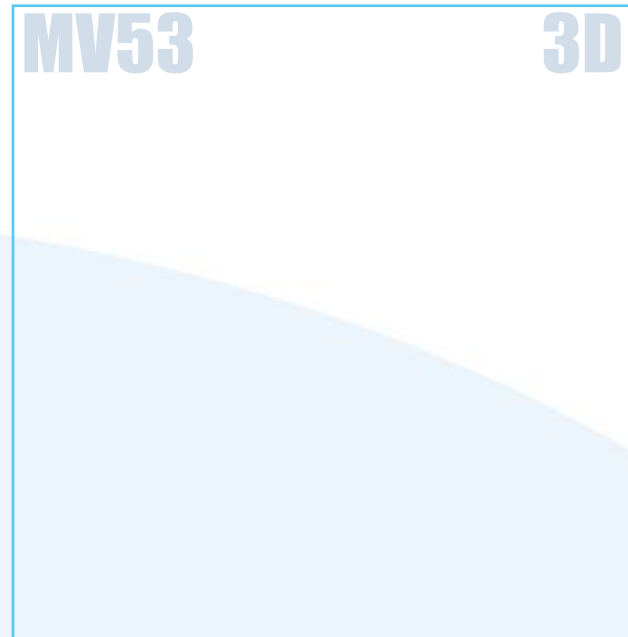
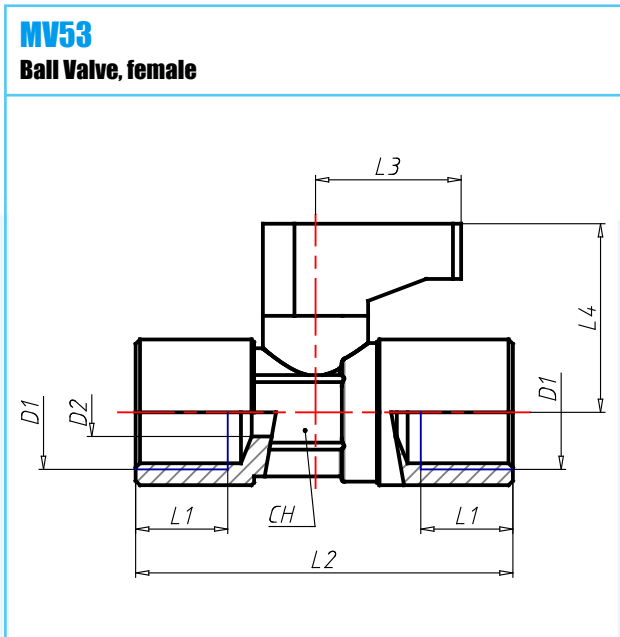

CODE	TYPE	D1	D2	D2IN	L1	L1IN	L2	L2IN	L3	L3IN	L4	L4IN	CH	G	GOZ	WTF	WPP	CONF
4430001	MV53 00 18	G1/8	5.5	.217	8.0	.315	36.5	1.437	19	.748	21.5	.846	14	37.3	1.316	-4 ÷ 176	145	RoHS
4430002	MV53 00 14	G1/4	5.5	.217	11.0	.433	43.0	1.693	19	.748	21.5	.846	14	49.5	1.746	-4 ÷ 176	145	RoHS
4430003	MV53 00 38	G3/8	8.0	.315	10.5	.413	43.0	1.693	24	.945	24.0	.945	17	74.5	2.628	-4 ÷ 176	145	RoHS
4430004	MV53 00 12	G1/2	10.0	.394	12.0	.472	49.0	1.929	34	1.339	27.0	1.063	21	138.9	4.900	-4 ÷ 176	145	RoHS