

**Material:** Brass Nickel Plated  
**Working Temperature:** -40 ÷ 150 C°  
**Working Temperature:** -40 ÷ 302 F°  
**Working Pressure (max):** 60 bar  
**Working Pressure (max):** 870 psi  
**Vacuum:** kPa  
**Vacuum:** Hg  
**Conformity:** RoHS

**Conformity:**  
**Conformity:**  
**Conformity:**  
**Conformity:**  
**Application** Pneumatic, hydraulic and oleodynamic circuits

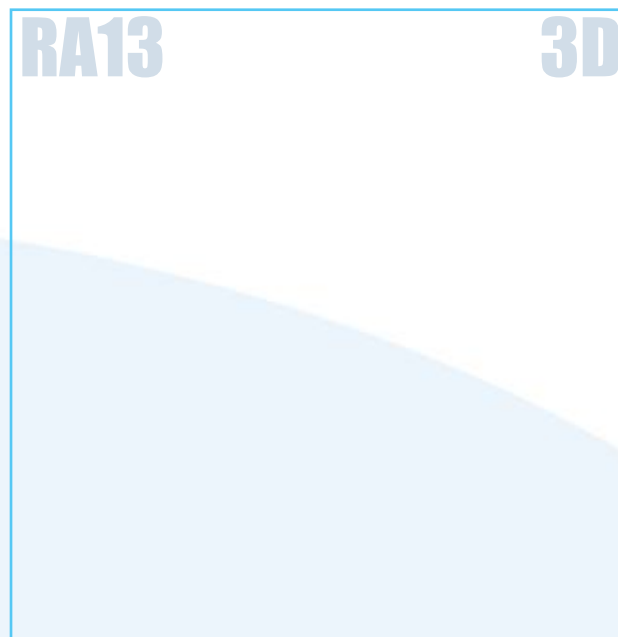
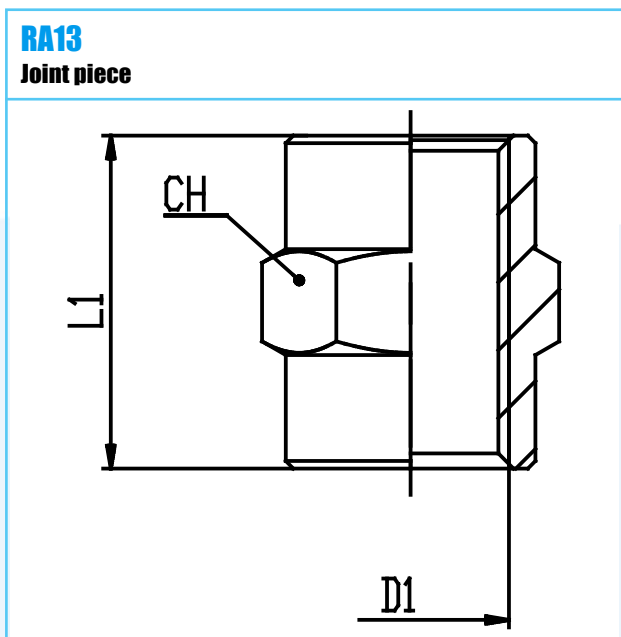

CODE	TYPE	D1	L1	L1IN	CH	G	OZ	WTF	WPP
5030000	RA13 00 M5	M5x0,8	11	.433	8	2.0	.071	-40 ÷ 302	870
5030001	RA13 00 18	G1/8	15	.591	14	9.8	.346	-40 ÷ 302	870
5030002	RA13 00 14	G1/4	22	.866	17	19.1	.674	-40 ÷ 302	870
5030003	RA13 00 38	G3/8	23	.906	22	34.5	1.217	-40 ÷ 302	870
5030004	RA13 00 12	G1/2	28	1.102	26	48.4	1.707	-40 ÷ 302	870
5030005	RA13 00 34	G3/4	32	1.260	32	98.4	3.471	-40 ÷ 302	870
5030006	RA13 00 1	G1"	35	1.378	38	97.8	3.450	-40 ÷ 302	870