

Material: Brass Nickel Plated
Working Temperature: -40 ÷ 150 C°
Working Temperature: -40 ÷ 302 F°
Working Pressure (max): 60 bar
Working Pressure (max): 870 psi
Vacuum: kPa
Vacuum: Hg
Conformity: RoHS

Conformity:
Conformity:
Conformity:
Conformity:
Application Pneumatic, hydraulic and oleodynamic circuits

RA25
Male-female, lateral tee

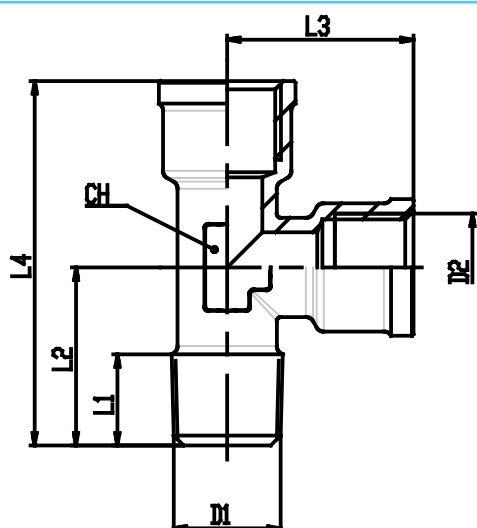

RA25 **3D**

CODE	TYPE	D1	D2	L1	L1IN	L2	L2IN	L3	L3IN	L4	L4IN	CH	G	OZ	WTF	WPP
5150001	RA25 18 18	R1/8	G1/8	8.2	.323	17.0	.669	18.5	.728	35.5	1.398	10	18.7	.660	-40 ÷ 302	870
5150002	RA25 14 14	R1/4	G1/4	11.0	.433	21.5	.846	22.5	.886	44.0	1.732	12	34.0	1.199	-40 ÷ 302	870
5150003	RA25 38 38	R3/8	G3/8	12.0	.472	24.5	.965	25.5	1.004	50.0	1.969	15	57.5	2.028	-40 ÷ 302	870
5150004	RA25 12 12	R1/2	G1/2	14.0	.551	29.5	1.161	30.0	1.181	59.5	2.343	19	95.9	3.383	-40 ÷ 302	870