

Material: Brass Nickel Plated
Working Temperature: -40 ÷ 150 C°
Working Temperature: -40 ÷ 302 F°
Working Pressure (max): 60 bar
Working Pressure (max): 870 psi
Vacuum: kPa
Vacuum: Hg
Conformity: RoHS

Conformity:
Conformity:
Conformity:
Conformity:
Application Pneumatic, hydraulic and oleodynamic circuits

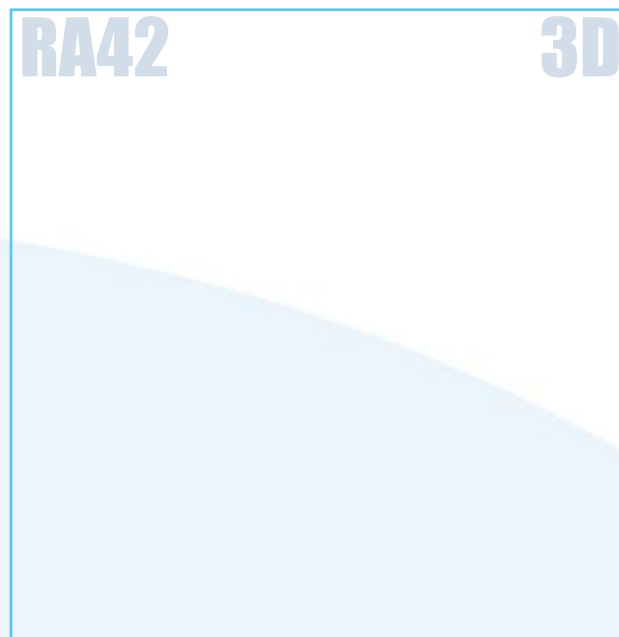
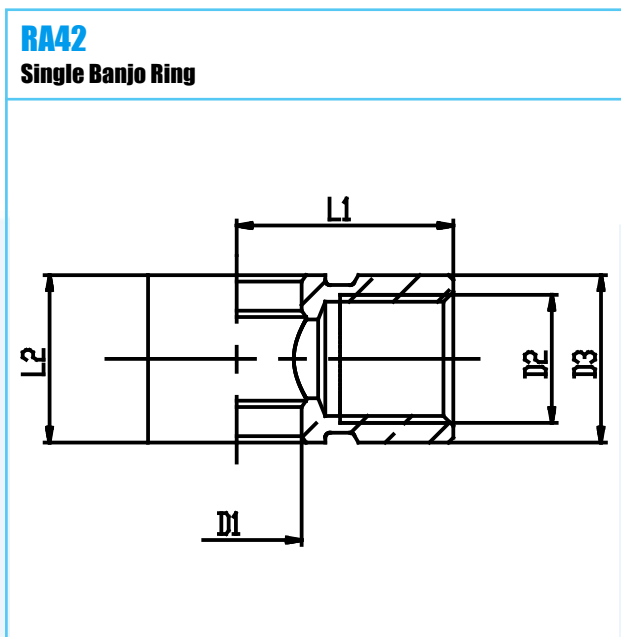

CODE	TYPE	D1	D1IN	D2	D3	D3IN	L1	L1IN	L2	L2IN	G	OZ	WTF	WPP
5320000	RA42 00 M5	5.1	.201	M5x0,8	9.0	.354	11.5	.453	10	.394	9	.317	-40 + 302	870
5320001	RA42 00 18	10.0	.394	G1/8	14.0	.551	16.0	.630	15	.591	15	.529	-40 + 302	870
5320002	RA42 00 14	13.2	.520	G1/4	17.0	.669	22.0	.866	17	.669	26	.917	-40 + 302	870
5320003	RA42 00 38	17.0	.669	G3/8	20.5	.807	26.0	1.024	20	.787	38	1.340	-40 + 302	870
5320004	RA42 00 12	21.0	.827	G1/2	25.0	.984	32.0	1.260	24	.945	66	2.328	-40 + 302	870
05320009	RA42 00 M5 /R	7.0	.276	M5x0,8	9.0	.354	11.5	.453	10	.394	6	.212	-40 + 302	870